

# Atlas Copco, BE



## Resilient Parts for Compressors

### CDM-ISO-PAD

<b>Job Type</b>	CDM is OEM of certain resilient components used in the compressors of Atlas Copco
<b>Start of supply</b>	since 1996
<b>Number of parts</b>	approx. 10
<b>Main product</b>	Corkrubber of the family CDM-CR
<b>Departments</b>	Oil-free and Industrial air

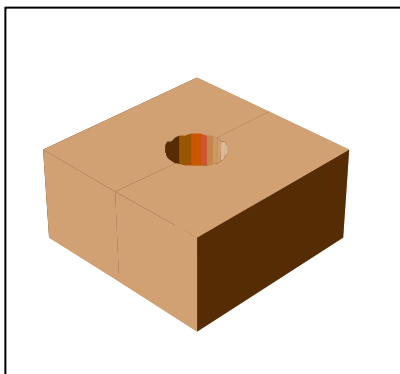

PAD CDM-64 40x40x20 Ø12mm

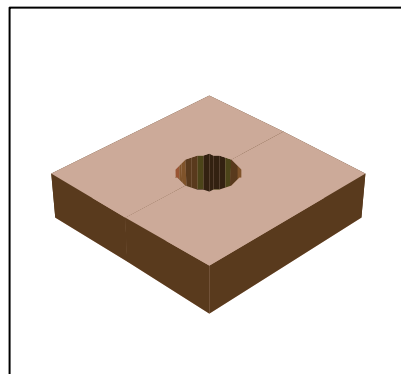

PAD CDM-62 40x40x10 Ø12mm

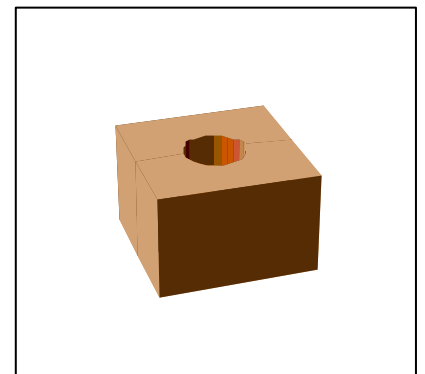

PAD CDM-64 30x30x20 Ø12mm

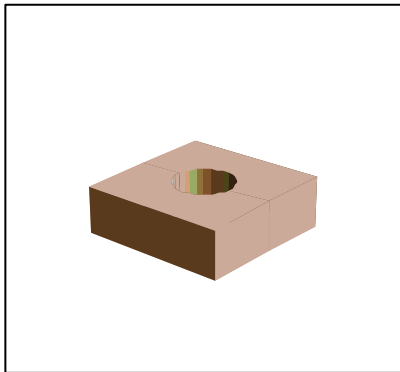

PAD CDM-62 30x30x10 Ø12mm

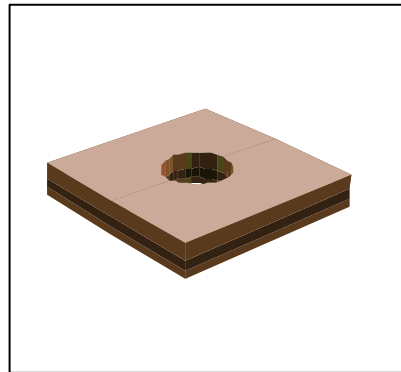

PAD CDM-62/71 50x50x8,5 Ø17mm

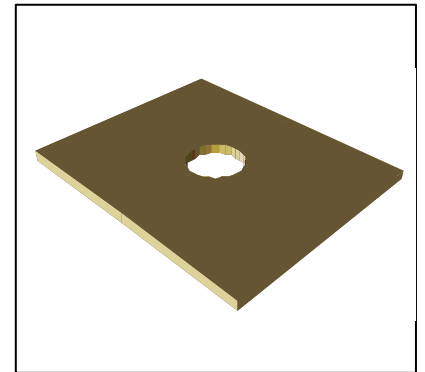

PAD CDM-61 120x100x5 Ø26mm

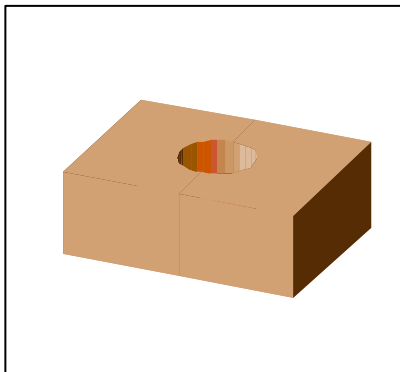

PAD CDM-64 40x30x15 Ø13mm

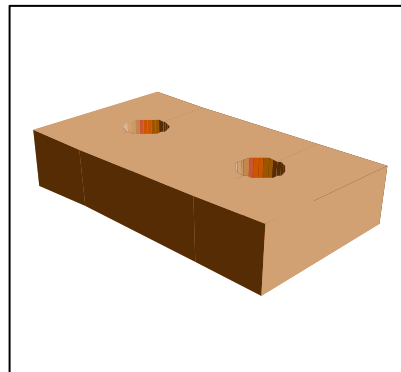

PAD CDM-64 100x55x15 2x Ø15mm

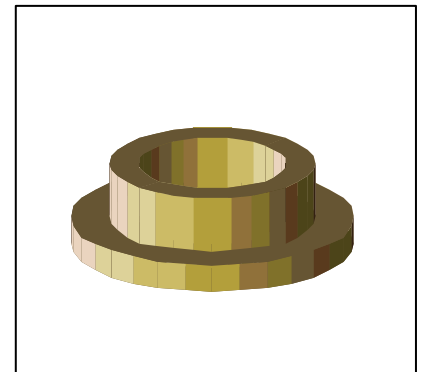

WASHER CDM-61 50/26/5 + 36/26/10

## CASE STUDY – CDM-ISO-INDUSTRY

CDM-UK  
PO Box 7035  
Melton Mowbray  
Leics LE13 1WG



T: + 44 (0) 1664 482486  
F: +44 (0) 1664 482487  
E: info@cdm-uk.co.uk  
www.cdm-uk.co.uk