

London Stock Exchange

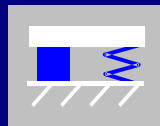

Dry Floating Floor CDM-ISO-T-SPECIAL



The new Stock Exchange

Main Contractor
Architect
Acoustic Consultant
Partner
Area

Interior PLC
Gensler
Sandy Brown Associates
Quintec Refurbishments
200m²

The London Stock Exchange is soon to move to its new location near St Paul's Cathedral in the centre of London's financial district.

The new development includes an auditorium which will be used for conferences, important presentations to large audiences etc..



The new Stock Exchange

Sandy Brown Associates specified that there had to be a dry floating floor system in the Auditorium and Control Room to protect from noise generated in the retail and leisure areas below. The floor was specified to have a minimum of 45mm timber boarding over a 100mm void with bearings that have a maximum natural frequency of 13Hz.

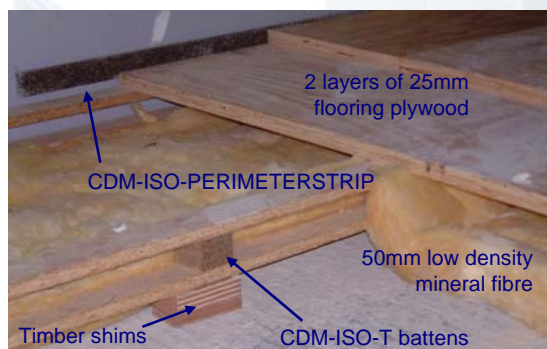

CDM-UK, working with Quintec, designed, manufactured and installed a system based on the CDM-ISO-T resilient batten. The batten consists of 50mm x 50mm x 40mm CDM15 isolation bearings fixed between 2 timber strips. Each bearing was then shimmed to ensure that the top level of the floor met a level that was 150mm above the structural level.



CDM-ISO-T battens in the control room

The bearings were designed to deflect 3.5mm under the imposed loading and give a bearing natural frequency of 12Hz.



The entrance to the auditorium



The finished floor in the auditorium



The Auditorium nearing completion

CASE STUDY – CDM-ISO-FLOOR

CDM-UK
PO Box 7035
Melton Mowbray
Leics LE13 1WG



noise & vibration control

T: + 44 (0) 1664 482486
F: +44 (0) 1664 482487
E: info@cdm-uk.co.uk
www.cdm-uk.co.uk